

GALEON

propulsion

TWIN VOLVO PENTA D13-1000
(T-1000 HP - 746 KW)

OPTIONAL: MAN TWIN 1200HP
(T-1200 HP - 882 KW)

*cruising speed** 23 KNOTS

*maximum speed** 27 KNOTS

length overall 64' 7" / 19.68 M

hull length 57' 8" / 17.6 M

beam 16' 6" / 5.05 M

beam (balcony down) 23' 1" / 7.05 M

dry weight 88,926 LB / 40,336 KG

maximum load weight 101,095 LB / 45,856 KG

draft (maximum) 3' 2" / .99 M

height (including mast light) 20' 8" / 7.42 M

fuel capacity 924 GAL / 3,500 L

water capacity 132 GAL / 500 L

black water capacity 55 GAL / 210 L

grey water capacity 71 GAL / 270 L

The specification measurements are approximate and subject to variance.

**The listed performance data is an estimate only based on vessel testing on fresh water with 6 people, full fuel and water and a clean hull bottom. The performance will change based on boating location, vessel loading and maintenance.*



Features abound. Fold-out Beach Mode balconies with access from cockpit and deck level. Alfresco dining settee aft.

Loads of glazing along the hull sides combine with massive windows on the main deck to create an airy and futuristic look.



This enormous stateroom provides a comfortable and quiet oasis for the owner when it's time to get away.



The 620 FLY stuns with its dynamic two-tone hull, wide beam, and expansive glazed windows, ensuring breathtaking views and a sunlit main deck. The flybridge offers U-shaped seating, a redesigned wet bar, and an automated sunroof, while an optional fabric awning provides extra shade. At the stern, choose between free-standing sun loungers or a spacious seating zone, creating the ultimate relaxation space.

STANDARD FEATURES

EXTERIOR

Exterior Upholstery

- Tan & Mocha
- OR
- White & Mocha
- OR
- White & Silver

Hull & Deck Accessories

Bottom paint
Bow deck rail, 316 stainless steel with side access
Cleats, 16" stainless steel (8)
Fiberglass engine room air intakes and stainless steel outputs
Flooring, molded non-skid (bow and side deck)
Fusion radio RA205 with speakers (2) on bow
Handrails, 316 stainless steel (cockpit and side deck)
Horn, electric
Lights, navigation
Mooring System

- Electric anchor winch with helm station and foot switches
- Anchor roller
- Galvanized anchor with galvanized chain
- Lockable, fiberglass deck hatch to self-draining chain locker

Rubrail, PVC with stainless steel insert
Ship's bell
Spotlight, remote-controlled
Skylight, foredeck with opening rectangular hatch
Seating, foredeck
Sunpad, foredeck
Tables cockpit, foredeck
Thru-hull fittings, stainless steel
Windows, bonded tempered glass (hullside) with integrated polycarbonate opening portholes
Windshield, bonded tempered and tinted glass
Windshield defroster
Flybridge, extended

Cockpit

Door, salon entrance – three segment, stainless steel and glass, folding and lockable with flush threshold
Handrails, 316 stainless steel
Hatch, engine room access

Lighting, indirect LED (cockpit and stairs)
Lighting, overhead LED
Seat, dual, aft facing
Self-draining
Sofa, C-shaped upholstered with aft sunpad
Cupholders
Speakers (2)
Stairs, access to flybridge (molded fiberglass with teak treads and stainless steel handrail)
Storage, side lockers
Table
Teak, cockpit sole

Stern

Cleats, stainless steel (2)
Crew cabin

- A/C
- Bed, two singles
- Door, transom with stairs
- Lighting, overhead LED
- Outlet, 120V
- Portlight
- Storage, cabinetry
- Wardrobe with stainless steel rod and shelving
- Crew head
- Shower
- Sink with faucet
- Toilet with electric pump and macerator

Door, cockpit access (stainless steel and acrylic)
Lighting, indirect LED
Shore power inlets, 240V
Shower, fresh water (hot and cold)
Stairs, access to cockpit (molded, starboard)
Storage, side lockers
Swim platform, hydraulic with connecting stairway, adjustable chocks, collapsible three-step stainless steel swim ladder, and teak decking

Flybridge

Flooring, molded non-skid
Self-draining
Handrails, 316 stainless steel
Helm station

- Compass
- Cupholders
- Helm seat, doublewide
- Outlets, USB

- Station instruments and controls
 - Engine data display
 - Switches
 - Thruster control panel
 - Fire system monitor
 - Engine ignition panel
 - Trim tab control panel
 - Dual lever control, EVC
- Steering wheel, exclusive Galeon
- Stereo, Fusion 12V AM/FM with bluetooth module and speakers (2)

Fiberglass arch with stainless steel radar mast
Hatch, flybridge access
Light, anchor
Lighting, indirect LED
Outlet, 120V GFI protected
Seating, doublewide sofa adjacent to captain's seat
Seating, U-shape upholstered
Sunpad, forward
Table, foldable fiberglass
Venturi wind deflector, plexiglass with 316 stainless steel rails
Wetbar with:

- Fiberglass sink and retractable faucet
- Refrigerator (2.2 ft³/62 L)
- Storage

INTERIOR

Interior Color & Materials

Cabinetry

- Mediterranean Design Package
 - Ivory
 - Ocean
 - Pearl
 - Terra
 - Amber

(Please ask Sales Consultant for additional information or refer to sales brochure.)

Interior Upholstery

- White
- OR
- Beige

Window Treatments

- Roman shades

Salon/Dinette

Carbon monoxide detector
Flooring, carpet
Corridor stairs, dual with indirect LED spot lights
Blinds, salon entrance door
Lighting, overhead LED with wood detailing
Outlet, 120V
Seating, C-shape sofa with hi-lo wood table with storage below
Side windows, panoramic with window treatments
Storage, cabinets
Wetbar, sink and storage forward
Bow access through windshield

Galley

Cooktop, 240V two-burner induction
Corian worktop with Corian shelf
Extractor fan, overhead
Lighting, accent LED
Lighting, overhead LED with wood detailing
Microwave
Outlets, 120V GFI protected
Refrigerator, under counter with freezer compartment (5.8 ft³/165 L)
Side windows, panoramic with window treatments
Storage, cabinets and overhead cupboards
Storage, dedicated glass storage
Twin stainless steel sinks with faucet and wood cutting board
Breakfast bar, starboard
Waterproof wood look floor

Helm Station (main, lower)

A/C vents
Compass
Cupholders
Outlets, USB
Station instruments and controls

- Volvo 7" digital Electronic Vessel Control (EVC) panel
- Switches
- Fire system monitor
- Engine start panel
- Trim tab control panel
- Dual lever control, EVC
- Rudder indicator
- Alarm, high water – bilge (2), cabin



STANDARD FEATURES

Seat, dual captain's seats with armrests
Steering wheel, exclusive Galeon
Synchronized twin windscreen wipers with front
window washing system and defroster outlets

Master Cabin (full beam, amidship)

Carbon monoxide detector
Door, private access to owner's head and shower
with full length mirror
Bed, queen-size, centerline with polyurethane
high resilience foam mattress, bed cover and
storage below
Flooring, carpet
Headboard, decorative with adjacent reading
lamps
Lighting, accent LED
Lighting, overhead LED
Lighting, skylight LED
Nightstands with storage, port and starboard
Outlets, 120V
Side windows, panoramic with window treatments
Seating, port side twin seat with storage between
Sound system, Bose® SoundTouch® 120 with
soundbar and Acoustimass® module
Storage, cabinet
TV LED 32"
Vanity with stool
Wardrobe, port and starboard

Master Head & Shower

A/C vent
Bathroom accessories – toothbrush holder, towel
hooks, soap dispenser, toilet paper holder
Cabinets, mirrored
Corian countertop with ceramic bowl and
chrome faucet
Extractor fan
Flooring, molded fiberglass non-slip
Lighting, overhead LED
Outlet, 120V GFI protected
Porthole, opening tinted with mosquito net
Storage, cabinets and shelving
Toilet with electric pump and macerator
Separate shower area with hinged plexiglass door
• Corian panel
• Chrome shower system with overhead
rain shower
• Floor drain
• Shower tile mosaic

Forward Guest Cabin

Carbon monoxide detector
Door, private access to guest head and shower
with full length mirror
Bed, queen-size, centerline with polyurethane
high resilience foam mattress, bed cover and
drawer storage below
Flooring, carpet
Headboard, decorative with adjacent reading
lamps
Lighting, accent LED
Lighting, overhead LED
Outlets, 120V
Portholes, opening tinted inserts in main windows
(port and starboard) with mosquito nets
Side windows with window treatments
Skylight, foredeck with opening rectangular hatch
and manual blinds
Storage, overhead and adjacent cabinets (port
and starboard)
Stairs, private entrance
Vanity with stool
Wardrobe with lighted stainless steel rod

Forward Head & Shower

A/C vent
Bathroom accessories – toothbrush holder, towel
hooks, soap dispenser, toilet paper holder
Cabinet, mirrored
Corian countertop with ceramic bowl and
chrome faucet
Extractor fan
Flooring, molded fiberglass non-slip
Lighting, overhead LED
Outlet, 120V GFI protected
Porthole, opening tinted with mosquito net
Storage, cabinet
Toilet with electric pump and macerator
Separate shower area with hinged plexiglass door
• Corian panel
• Chrome shower system with overhead
rain shower
• Floor drain
• Shower tile mosaic

Mid Guest Cabin (3-cabin layout)

Carbon monoxide detector
Beds, convertible twin with polyurethane high
resilience foam mattress, bed covers, and
storage below (filler to form double bed)

Flooring, carpet
Lighting, overhead LED
Lighting, reading lamps (2)
Outlet, 120V
Nightstand with storage drawer
Porthole, opening tinted insert in main window
with mosquito net
Side windows with window treatments
Storage, overhead cabinets
Wardrobes with lighted stainless steel rod

Port & Starboard Guest Stateroom (4-cabin layout)

Carbon monoxide detector
Door, private access to guest head and shower
with full length mirror
Bed, twin, with polyurethane high resilience foam
mattress, bed cover and storage below
Flooring, carpet
Lighting, overhead LED
Nightstand with storage drawer and reading lamp
Outlet, 120V
Porthole, opening tinted inserts in main window
with mosquito nets
Side windows with window treatments
Storage, overhead cabinets
Wardrobe with lighted stainless steel rod

Guest Head & Shower

A/C vent
Bathroom accessories – toothbrush holder, towel
hooks, soap dispenser, toilet paper holder
Cabinets, mirrored
Corian countertop with ceramic bowl and
chrome faucet
Extractor fan
Flooring, molded fiberglass non-slip
Lighting, overhead LED
Outlet, 120V GFI protected
Porthole, opening tinted with mosquito net
Storage, cabinet
Toilet with electric pump and macerator
Separate shower area with hinged plexiglass door
• Cabinet, mirrored
• Corian panel
• Chrome shower system
• Floor drain

Crew Cabin

Beds, (2) twin
Refrigerator
Microwave
Storage
Head with shower and sink
Engine room access
Lighting, LED
Window for natural light

SYSTEMS

Power & Drive Systems

2x Volvo Penta D13-1200 (2x 1200 HP/882 kW)
diesel engines
• Straight shaft transmission
• Propellers and rudder (bronze)
• Propeller shafts (stainless steel)
• Electronic Vessel Control System
• Exhaust, underwater
Bow thruster, electric
Hydraulic steering system
Trim tabs interceptors with indicators

Bilge

Automatic/manual fire extinguishing system
Bilge pumps, automatic electric (3)
Bilge pumps, high water alarm
Common drain system
Extractor fans (2)
Ladder, stainless steel
Lighting, LED
Sound insulation

Air Conditioning

Air Conditioning System, Dometic Chilled water
(108,000 BTU) – 240V

Electrical Systems

DC Electrical System (24V)
• Batteries, engine starting
• Batteries, service
• Battery, bow thruster
• Battery charger/converter, 120V/12V
• Circuit breakers
• Integrated Management Information System
(IMIS), Raymarine
• Digital switching system, EmpireBus



STANDARD FEATURES

AC Electrical System (240V)

- Shore power, 240V/50A with 50 ft. cords
- Circuit breakers
- AC main control panel
- Generator, Onan 29 kW diesel with sound shield (120/240V)
- Zincs

Electronics

Raymarine VHF radio with Automatic Identification System (AIS) receiver, remoter speaker, repeater, and antenna

Raymarine Autopilot with control units at main and flybridge helm stations

Fuel System

Fuel tanks (2), 316 stainless steel with air releases

Fuel filters, (2) engines, (1) generator

Fuel lines, USCG – Type A-1

Fuel inlet, port and starboard aft deck

Fuel stop valve, electromagnetic

Fuel transfer system, manual valve

Fresh Water System

Water tank, stainless steel with air releases

Water inlet, stainless steel

Water pump, 12V with filter

Water heater, 120V (21 GAL/80 L)

Dockside/shore water connection

Level indicator on IMIS

Waste System

Black Water Waste System

- Water tank, stainless steel with odor filter, water level sensor, and air release
- Waste pump, electric
- Level indicator on IMIS
- Dockside pumpout fitting – stainless steel (starboard aft deck)
- Overboard waste discharge fitting

OTHER ITEMS

Owner's manual and engine manual

FACTORY OPTIONS

Color & Materials

Cabinetry

- Gloss Dark Walnut
- OR
- Gloss Beachwood

Mediterranean Design Package

- Please ask Sales Consultant for additional information or refer to sales brochure

Interior Upholstery

- White (Walnut Cabinetry)
- OR
- White and Grey (Beachwood Grey Cabinetry)

Comfort Pack (choose individually)

Artistic Teak and rope divider for helm and salon

Laminated hardtop on flybridge with electric soft roof

Stern thruster, electric

2x cablemaster

Cover for flybridge steering console

Cover for seats near flybridge steering console

Cover for galley on flybridge

Cover for bow sofa on flybridge

Cover for sofa in cockpit

Cover for sundeck on the bow

Covers for front window and side windows - black net structure

IMIS (Integrated Management and Information System) – Chartplotter required

Raymarine Chartplotter/FF 2x AxiomXL 16 (2x Main Station) 1x Axiom2 12 Pro-S with integrated high chirp sonar for CPT-S (1x FLY) + CP370 Transducer B744V + Cyclone 4ft Open Array

Raymarine VHF Ray91 (or Ray90 if AIS 700) + VHF antenna (with repeater on fly/sky)

Raymarine Autopilot Evolution DBW with 2xP70RS, EV2 Sensor Core, EV2 cabling

Electric sliding TV LED HD 43" in salon with soundbar

TV LED 43" in master cabin

Luxury Pack (choose individually)

Beach Mode package – foldable aft balconies and sliding openable aft side windows, convertible bar area in side cockpit

Waterproof wood look floor in salon and galley

Carpets on floor in salon and galley

Electric grill on flybridge and minibar (230V)

Ice maker in flybridge minibar

Washer and dryer (separate units)

Underwater LED lights (12)

Rear view camera + engine compartment camera (2)

Large refrigerator in aft salon

Lighting, ambient LED in master

Satellite TV KVH TracVision HD7

Soundbar system in salon

Soundbar system in aft cabin

Fusion radio in salon (USB, 2 speakers) + Radio on flybridge (2 speakers)

Upgraded G3 sound system in salon & galley with 2 subwoofers + Fusion RA770 + remote on fly

2x 7.7" speakers in cockpit + 2x 7.7" speakers on fly

Audio system Fusion on bow (2 speakers)

TV LED 43" in forward cabin

Electric sliding TV LED HD 43" in salon (bow)

Electric sliding TV LED HD 43" in salon (galley) on with galley island

Electric sliding TV LED HD 43" in salon (facing cockpit)

Individual Options

Gyro stabilizer (1x Seakeeper 9)

Custom flybridge aft sofa

Cover for flybridge aft sofa

Dishwasher in galley

Drawer refrigerator in passage to the front deck

Additional exterior bar stools (2)

Wine cooler in salon

Anchor and chain (50 KG, 10/100 M), stainless steel

Electric sunshade for aft flybridge lounge

Teak on flybridge, bathplatform, balconies, cockpit deck, steps to flybridge, lower side decks, upper side decks, and front deck

4-cabin layout

Fitted sheet set except crew cabin

Fitted sheet crew cabin, one bed



LAYOUT

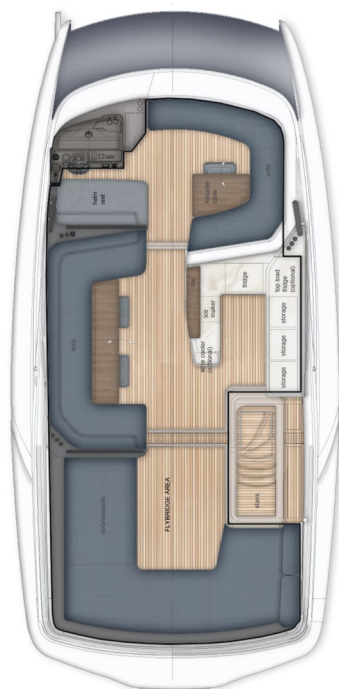

FLYBRIDGE



MAIN DECK



LOWER DECK



LOWER DECK - OPTION 2

The right is reserved to make changes, without notice, at any time, in equipment, materials, and specifications. Drawings, photos, and renderings may show optional equipment.



