

Y
E
L
D
O
O
O

propulsion

TWIN MAN V8 TURBO 1200 HP
(T-1200 HP - 882 kW)

<i>cruising speed*</i>	28 KNOTS
<i>maximum speed*</i>	32 KNOTS

length overall 72' 10" / 22.0 M

hull length 66' 2" / 20.18 M

beam 17' 3" / 5.27 M

dry weight 85,010 LB / 38,560 KG

maximum load weight 98,656 LB / 44,750 KG

draft (maximum) 4' 7" / 1.43 M

height (including mast light) 26' 2" / 8.0 M

fuel capacity 879 GAL / 3,330 L

water capacity 211 GAL / 800 L

black water capacity 79 GAL / 300 L

The specification measurements are approximate and subject to variance.

**The listed performance data is an estimate only based on vessel testing on fresh water with 6 people, full fuel and water and a clean hull bottom. The performance will change based on boating location, vessel loading and maintenance.*



An enormous foredeck lounge features multiple settees and sunpads to help keep the party going.

Twin helm chairs and plush U-shaped seating around a forward dining settee are hallmarks of the luxury you'll find aboard this yacht.



Massive hullside windows keep the 680 FLY's master stateroom bathed in lustrous natural light.



The 680 FLY is a perfect evolution utilizing lightweight carbon fiber technologies and powerful engines to deliver stunning performance. Her design delivers more game changing features with an expandable bow and a few other surprises. Aboard you will find a light and welcoming salon with luxurious finishes while the expansive flybridge awaits your next party or family gathering.



STANDARD FEATURES

EXTERIOR

Exterior Upholstery

- Tan & Mocha
- OR
- White & Mocha
- OR
- White & Silver

Hull & Deck Accessories

Bottom paint
 Bow deck rail, 316 stainless steel with side access
 Cleats, 16" stainless steel (8)
 Fiberglass engine room air intakes and stainless steel outputs
 Flooring, molded non-skid (bow and side deck)
 Handrails, 316 stainless steel (cockpit and side deck)
 Horn, electric
 Lights, navigation
 Mooring System

- Electric anchor winch with helm station and foot switches
- Anchor roller
- Galvanized anchor with galvanized chain
- Lockable, fiberglass deck hatch to self-draining chain locker

 Rubrail, PVC with stainless steel insert
 Ship's bell
 Spotlight, remote-controlled
 Skylight, foredeck with opening rectangular hatch
 Seating, foredeck
 Sunpad, foredeck
 Tables cockpit, foredeck
 Thru-hull fittings, stainless steel
 Windows, bonded tempered glass (hullside) with integrated polycarbonate opening portholes
 Windshield, bonded tempered and tinted glass
 Windshield defroster
 Flybridge, extended

Cockpit

Door, salon entrance – three segment, stainless steel and glass, folding and lockable with flush threshold
 Handrails, 316 stainless steel
 Hatch, engine room access
 Lighting, indirect LED (cockpit and stairs)
 Lighting, overhead LED

Self-draining
 Sofa, C-shaped upholstered
 Cupholders
 Speakers (2)
 Stairs, access to flybridge (molded fiberglass with teak treads and stainless steel handrail)
 Storage, side lockers
 Table
 Teak, cockpit sole

Stern

Cleats, stainless steel (2)
 Crew cabin

- A/C
- Bed, two singles
- Door, transom with stairs
- Lighting, Overhead LED
- Outlet, 120V
- Portlight
- Storage, cabinetry
- Wardrobe with stainless steel rod and shelving
- Crew head
- Shower
- Sink with faucet
- Toilet with electric pump and macerator

 Door, cockpit access (stainless steel and acrylic)
 Lighting, indirect LED
 Shore power inlet, 240V
 Shower, fresh water (hot and cold)
 Stairs, access to cockpit (molded, starboard)
 Storage, side lockers
 Swim platform, hydraulic with connecting stairway, adjustable chocks, collapsible three-step stainless steel swim ladder, and teak decking

Flybridge

Flooring, molded non-skid
 Self-draining
 Handrails, 316 stainless steel
 Helm station

- Compass
- Cupholders
- Helm seat, dual captain's chairs
- Outlets, USB
- Station instruments and controls
 - Engine data display
 - Switches
 - Thruster control panel

- Fire system monitor
- Engine ignition panel
- Trim tab control panel
- Dual lever control, EVC
- Steering wheel, exclusive Galeon
- Stereo, Fusion 12V AM/FM with bluetooth module and speakers (2)

 Fiberglass arch with stainless steel radar mast
 Hatch, flybridge access
 Light, anchor
 Lighting, indirect LED
 Outlet, 120V GFI protected
 Seating, U-shape upholstered sofa
 Sunpad, forward
 Table, adjustable fiberglass
 Venturi wind deflector, plexiglass with 316 stainless steel rails
 Wetbar with:

- Fiberglass sink and retractable faucet
- Refrigerator (2.2 ft³/62 L)
- Storage

INTERIOR

Interior Color & Materials

Cabinetry

- Dark Walnut Matte
- OR
- Beachwood Matte

 Interior Upholstery

- White
- OR
- Beige

 Window Treatments

- Roman shades

Salon/Dinette

Carbon monoxide detector
 Flooring, carpet
 Corridor stairs, dual with indirect LED spot lights
 Blinds, salon entrance door
 Lighting, overhead LED with wood detailing
 Outlet, 120V
 Seating, C-shape sofa with hi-lo wood table with storage below
 Side windows, panoramic with window treatments
 Storage, cabinets

Galley

Cooktop, 240V two-burner induction
 Corian worktop with Corian shelf
 Extractor fan, overhead
 Lighting, accent LED
 Lighting, overhead LED with wood detailing
 Microwave
 Outlets, 120V GFI protected
 Refrigerator, under counter with freezer compartment (5.8 ft³/165 L)
 Side windows, panoramic with window treatments
 Storage, cabinets and overhead cupboards
 Storage, dedicated glass storage
 Twin stainless steel sinks with faucet and wood cutting board
 Breakfast nook, starboard
 Waterproof wood look floor

Helm Station (main, lower)

A/C vents
 Compass
 Cupholders
 Outlets, USB
 Station instruments and controls

- Engine data display
- Switches
- Thruster control panel
- Fire system monitor
- Engine start panel
- Trim tab control panel
- Dual lever control, EVC
- Rudder indicator
- Alarm, high water – bilge (2), cabin

 Seat, dual captain's seats with armrests
 Steering wheel, exclusive Galeon
 Synchronized twin windscreen wipers with front window washing system and defroster outlets

Master Cabin (full beam, amidship)

Carbon monoxide detector
 Door, private access to owner's head and shower with full length mirror
 Bed, queen-size, centerline with polyurethane high resilience foam mattress, bed cover and storage below
 Flooring, carpet
 Headboard, decorative with adjacent reading lamps



STANDARD FEATURES

Lighting, accent LED
 Lighting, overhead LED
 Nightstands with storage, port and starboard
 Outlets, 120V
 Side windows, panoramic with window treatments
 Seating, starboard twin seat with storage both sides
 Sound system, Bose® SoundTouch® 120 with soundbar and Acoustimass® module
 Storage, cabinet
 TV LED 32" with Blu-ray player
 Vanity with stool
 Wardrobe, starboard
 Stairs, private entrance

Master Head & Shower

A/C vent
 Bathroom accessories – toothbrush holder, towel hooks, soap dispenser, toilet paper holder
 Cabinets, mirrored
 Corian countertop with ceramic bowl and chrome faucet
 Extractor fan
 Flooring, tile
 Lighting, overhead LED
 Outlet, 120V GFI protected
 Porthole, opening tinted with mosquito net
 Storage, cabinets and shelving
 Toilet with electric pump and macerator
 Separate shower area with hinged plexiglass door

- Corian panel
- Chrome shower system with overhead rain shower
- Floor drain
- Shower tile mosaic

Forward Guest Cabin

Carbon monoxide detector
 Door, private access to guest head and shower with full length mirror
 Bed, queen-size, centerline with polyurethane high resilience foam mattress, bed cover and drawer storage below
 Flooring, carpet
 Headboard, decorative with adjacent reading lamps
 Lighting, accent LED
 Lighting, overhead LED
 Outlets, 120V

Portholes, opening tinted inserts in main windows (port and starboard) with mosquito nets
 Side windows with window treatments
 Skylight, foredeck with opening rectangular hatch and manual blinds
 Storage, overhead and adjacent cabinets (port and starboard)
 Wardrobe with lighted stainless steel rod

Forward Head & Shower

A/C vent
 Bathroom accessories – toothbrush holder, towel hooks, soap dispenser, toilet paper holder
 Cabinet, mirrored
 Corian countertop with ceramic bowl and chrome faucet
 Extractor fan
 Flooring, tile
 Lighting, overhead LED
 Outlet, 120V GFI protected
 Porthole, opening tinted with mosquito net
 Storage, cabinet
 Toilet with electric pump and macerator
 Separate shower area with hinged plexiglass door

- Corian panel
- Chrome shower system with overhead rain shower
- Floor drain
- Shower tile mosaic

Port & Starboard Guest Stateroom

Carbon monoxide detector
 Bed, twin, with polyurethane high resilience foam mattress, bed cover and storage below
 Flooring, carpet
 Lighting, overhead LED
 Nightstand with storage drawer and reading lamp
 Outlets, 120V
 Side windows with window treatments
 Storage, overhead cabinets
 Wardrobe with lighted stainless steel rod

Guest Head & Shower

A/C vent
 Bathroom accessories – toothbrush holder, towel hooks, soap dispenser, toilet paper holder
 Cabinet, mirrored
 Corian countertop with ceramic bowl and chrome faucet
 Extractor fan

Flooring, tile
 Lighting, overhead LED
 Outlet, 120V GFI protected
 Storage, cabinet
 Toilet with electric pump and macerator
 Separate shower area with hinged plexiglass door

- Corian panel
- Chrome shower system
- Floor drain
- Cabinet, mirrored

SYSTEMS

Power & Drive Systems

2x MAN V8 1200 HP TURBO diesel engines

- Straight shaft transmission
- Propellers and rudder (bronze)
- Propeller shafts (stainless steel)
- Electronic Vessel Control System
- Exhaust, underwater

Bow thruster, electric
 Hydraulic steering system
 Trim tabs interceptors with indicators

Bilge

Automatic/manual fire extinguishing system
 Bilge pumps, automatic electric (3)
 Bilge pumps, high water alarm
 Common drain system
 Extractor fans (2)
 Ladder, stainless steel
 Lighting, LED
 Sound insulation

Air Conditioning

Air Conditioning System, Dometic Chilled water (110,000 BTU) – 240V

Electrical Systems

DC Electrical System (24V)

- Batteries, engine starting
- Batteries, service
- Battery, bow thruster
- Battery charger/converter, 120V/12V
- Circuit breakers
- Integrated Management Information System (IMIS), Raymarine
- Digital switching system, EmpireBus

AC Electrical System (240V)

- Single 240V/100 AMP shore power inlet
- Circuit breakers
- AC main control panel
- Diesel generator with sound shield
- Zincs

Electronics

Raymarine VHF radio with Automatic Identification System (AIS) receiver, remoter speaker, repeater, and antenna
 Raymarine Autopilot with control units at main and flybridge helm stations

Fuel System

Fuel tanks (2), 316 stainless steel with air releases
 Fuel filters, (2) engines, (1) generator
 Fuel lines, USCG – Type A-1
 Fuel inlets, port and starboard aft deck
 Fuel stop valve, electromagnetic
 Fuel transfer system, manual valve

Fresh Water System

Water tank, stainless steel with air releases
 Water inlet, stainless steel
 Water pump, 12V with filter
 Water heater, 120V (21 GAL/80 L)
 Dockside/shore water connection
 Level indicator on IMIS

Waste System

Black Water Waste System

- Water tank, stainless steel with odor filter, water level sensor, and air release
- Waste pump, electric
- Level indicator on IMIS
- Dockside pumpout fitting – stainless steel (starboard aft deck)
- Overboard waste discharge fitting

OTHER ITEMS

Owner's manual and engine manual



FACTORY OPTIONS

Color & Materials

Cabinetry

- Gloss Dark Walnut
- OR
- Gloss Beachwood

Mediterranean Design Package

- Please ask Sales Consultant for additional information or refer to sales brochure

Interior Upholstery

- White (Walnut Cabinetry)
- OR
- White and Grey (Beachwood Grey Cabinetry)

Comfort Pack

Stern thruster, electric with IP protection

Cablemaster

Covers for front window and side windows - black net structure

Cover for seats near flybridge steering console

Cover for flybridge steering console

Cover for aft sofa on flybridge

Cover for bow sofa on flybridge

Cover for sundeck on the flybridge

Cover for sofa in cockpit

Cover for sundeck on the bow

Raymarine Chartplotter/FF 1x Axiom 12 RVM Pro-X US, 2x Axiom 16 RVM Pro-S with integrated high chirp sonar for CPT-S (2x main station and 1x flybridge) with transducer B744V and Cyclone 4ft Open Array

Electric sliding TV LED HD 50" with Blu-ray player in salon

Audio system Fusion on bow, speakers (2)

Fitted sheet set except crew cabin

Fitted sheet crew cabin, one bed

Luxury Pack

Artificial wood floor in salon

Carpets on wooden floor in salon and galley

Electric grill on flybridge

Ice maker in flybridge

Washer and dryer (separate units)

Underwater LED lights (12)

Rear view camera + engine compartment camera (2)

New type large refrigerator in aft salon

Bose® sound system in salon

TV LED 24" in guest cabins (2)

TV LED 32" in bow cabin

Safe in master cabin

Individual Options

Gyro stabilizer (1x Seakeeper 16)

Hydraulic bath platform with 1,764 LB/800 KG platform maximum capacity

Dishwasher in galley

Wine cooler

Electric horizontal aft flybridge sunshade

Raymarine augmented reality camera (AIS objects of the front camera screen)

Stainless steel anchor and chain (50 KG, 13/100 M)

Sunshade for front deck with carbon poles



LAYOUT

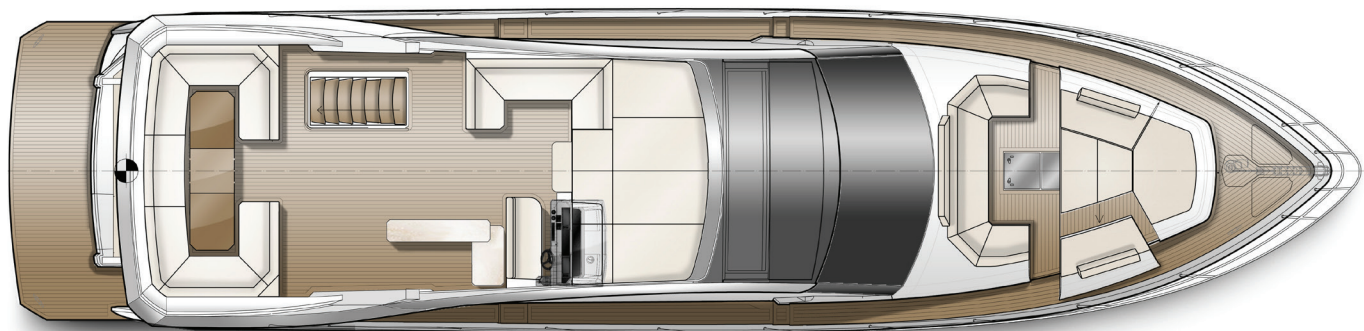

FLYBRIDGE

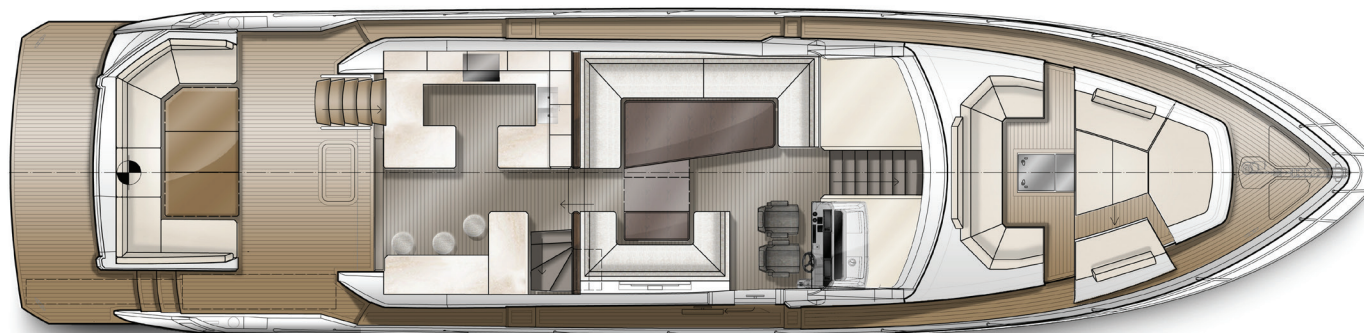

MAIN DECK

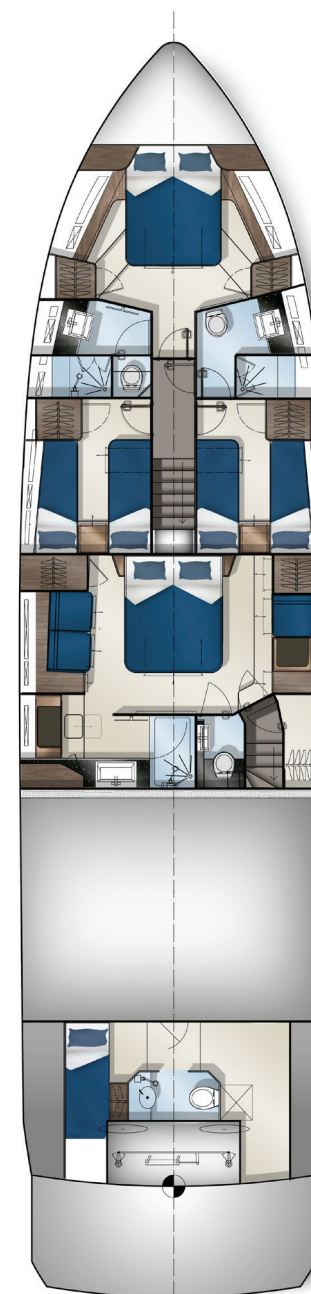

LOWER DECK

The right is reserved to make changes, without notice, at any time, in equipment, materials, and specifications. Drawings, photos, and renderings may show optional equipment.



