



propulsion

TWIN VOLVO PENTA D13-900
(T-900 HP - 662 kW)

cruising speed*	25 KNOTS
maximum speed*	30 KNOTS

length overall	58' 6" / 17.9 M
hull length	53' 5" / 16.31 M
beam	15' 10" / 4.6 M
beam (balcony down)	22' 4" / 6.83 M
dry weight	60,894 LB / 27,621 KG
maximum load weight	72,812 LB / 33,027 KG
draft (maximum)	4' 6" / 1.4 M
height (including mast light)	23' 4" / 7.13 M
fuel capacity	580 GAL / 2,200 L
water capacity	185 GAL / 700 L
black water capacity	53 GAL / 200 L
grey water capacity	53 GAL / 200 L

The specification measurements are approximate and subject to variance.

*The listed performance data is an estimate only based on vessel testing on fresh water with 6 people, full fuel and water and a clean hull bottom. The performance will change based on boating location, vessel loading and maintenance.



Loads of glazing along the hull sides combine with massive windows on the main deck to create an airy and futuristic look.



An expansive sunpad makes for an intimate setting for catching some rays, while also acting as another alfresco entertainment space.



The 560 FLY first grabs the eye with lines that are both muscular and playful. A wide beam that carries well forward gives this vessel a substantial presence. It's a design choice that pulls double duty, allowing for unmatched interior volume, particularly on the accommodations level. But the 560 FLY has other attractive exterior aesthetics at play as well. This is a yacht with lines to remember.

Features abound. Fold-out Beach Mode balconies have glazing, so guests can see the water below their feet. A bar with three stools is to port, while there is an alfresco dining settee aft.

Note: Layout and features may vary from shown here due to manufacturer consideration and client customization.



STANDARD FEATURES

EXTERIOR

Exterior Upholstery

- Tan & Mocha
- OR
- White & Mocha
- OR
- White & Silver

Hull & Deck Accessories

Bottom paint
 Bow deck rail, 316 stainless steel with side access
 Cleats, 16" stainless steel (8)
 Fiberglass engine room air intakes and stainless steel outputs
 Flooring, molded non-skid (bow and side deck)
 Handrails, 316 stainless steel (cockpit and side deck)
 Horn, electric
 Lights, navigation
 Mooring System

- Electric anchor winch with helm station and foot switches
- Anchor roller
- Galvanized anchor with galvanized chain
- Fiberglass deck hatch to self-draining chain locker

 Rubrail, PVC with stainless steel insert
 Spotlight, remote-controlled
 Skylight, foredeck with opening rectangular hatch
 Sunpad, foredeck

- Cupholders, plexiglass
- Handrails, stainless steel
- Mattresses, with convertible backrests

 Thru-hull fittings, stainless steel
 Windows, bonded tempered glass (hullside) with integrated opening portholes
 Windshield, bonded tempered and tinted glass
 Windshield defroster

Cockpit

Door, salon entrance – three segment, stainless steel and glass, folding and lockable with flush threshold
 Handrails, 316 stainless steel
 Lighting, indirect LED (cockpit and stairs)
 Lighting, overhead LED
 Self-draining

Sofa, L-shaped upholstered
 Speakers (2)
 Stairs, access to flybridge (molded fiberglass with teak treads and stainless steel handrail)
 Stairs, access to walkaround (molded, port, and starboard)
 Storage, side lockers
 Teak, cockpit sole

Stern

Cleats, 11" stainless steel (2)
 Door, cockpit access (fiberglass)
 Lighting, indirect LED
 Shore power inlet, 240V
 Shower, fresh water (hot and cold)
 Stairs, access to cockpit (molded, port)
 Storage, aft deck lazarette with transom entrance and engine room access
 Storage, side lockers
 Swim platform, extended with collapsible three-step stainless steel swim ladder and teak decking

Flybridge

Flooring, molded non-skid
 Handrails, 316 stainless steel
 Helm station

- Compass
- Cupholders
- Helm seat, doublewide
- Outlets, USB
- Station instruments and controls
 - 7" Volvo Electronic Vessel Control (EVC) panel
 - Switches
 - Fire system monitor
 - Engine ignition panel
 - Trim tab control panel
 - Dual lever control, EVC
- Steering wheel, exclusive Galeon
- Stereo, Fusion 12V AM/FM with bluetooth module and speakers (2)

 Fiberglass arch with foldable, stainless steel radar mast
 Hatch, flybridge access (plexiglass)
 Light, anchor
 Lighting, indirect LED
 Outlet, 120V GFI protected

Seating, U-shape upholstered sofa with storage below
 Sunpad, forward with convertible backrest support
 Table, fiberglass
 Venturi wind deflector, plexiglass with 316 stainless steel rails
 Wetbar with:

- Fiberglass sink and retractable faucet
- Refrigerator (1.7 ft³/49 L)
- Storage

INTERIOR

Interior Color & Materials

Cabinetry

- Dark Walnut Matte

 OR

- Beachwood Matte

 Window Treatments

- Roman shades

 Interior Color Scheme

- White

 OR

- Beige

Salon

Carbon monoxide detector
 Flooring, carpet
 Corridor stairs, carpeted with indirect LED spot lights
 Helm station (main)

- A/C vents
- Compass
- Cupholders
- Helm seat, rotating doublewide with wood footrest
- Outlets, USB
- Station instruments and controls
 - Volvo 7" digital Electronic Vessel Control (EVC) panel
 - Switches
 - Fire system monitor
 - Engine start panel with electronic key fobs
 - Trim tab control panel
 - Dual lever control, EVC
 - Rudder indicator

- Alarm, high water – bilge (2), cabin
- Steering wheel, exclusive Galeon
- Synchronized twin windscreen wipers with front window washing system and defroster outlets

 Lighting, overhead LED
 Outlet, 120V
 Seating, C-shape sofa with hi-lo wood dining table and filler cushion
 Seating, opposing sofa
 Side window, panoramic electrically opening (port and starboard)
 Speakers (2)
 Storage, wall cabinets

Galley (aft)

Cooktop, 240V two-burner induction
 Corian worktop with shelf
 Extractor fan, overhead
 Hatch, engine room access
 Lighting, accent LED
 Lighting, overhead LED
 Microwave, 120V
 Outlets, 120V GFI protected
 Refrigerator, 240V upright with freezer compartment (5.8 ft³/165 L)
 Refrigerator, 240V drawer (2.3 ft³/65 L)
 Storage, cabinets and overhead cupboards
 Sink, twin stainless steel with faucet and wood cutting board
 Waterproof wood look floor

Lower Corridor

Flooring, carpet
 Lower accommodation stairs, carpeted with indirect LED spot lights
 Door, access to guest head and shower with full length mirror

Master Cabin (full beam, amidship)

Carbon monoxide detector
 Door, private access to owner's head and shower with full length mirror
 Bed, queen-size, centerline with polyurethane high resilience foam mattress, bed cover and storage below
 Dressers, starboard side
 Flooring, carpet



STANDARD FEATURES

Headboard, decorative with adjacent reading lamps
 Lighting, accent LED
 Lighting, overhead LED with wood detailing
 Nightstands with storage (port and starboard)
 Outlets, 120V (port and starboard at nightstand)
 Sofa, port side with vanity table, shelves, and storage below
 Storage, cabinet (entry hallway)
 Wardrobe with lighted stainless steel rod

Master Head & Shower

A/C vent
 Bathroom accessories – toothbrush holder, towel hooks, soap dispenser, toilet paper holder
 Corian countertop with ceramic bowl and chrome faucet
 Extractor fan
 Flooring, molded fiberglass non-slip
 Lighting, overhead LED
 Mirror
 Outlet, 120V GFI protected
 Porthole, opening tinted with mosquito net
 Storage, cabinets and shelving
 Toilet with electric pump and macerator
 Separate shower area with hinged plexiglass door

- Corian panel
- Chrome shower system with overhead rain shower
- Floor drain
- Porthole, opening tinted with mosquito net
- Storage, cabinet

Bow Guest Cabin

Carbon monoxide detector
 Door, private access to guest head and shower with full length mirror
 Berth, queen-size with polyurethane high resilience foam mattress, bed cover and drawer storage below
 Flooring, carpet
 Headboard, decorative with adjacent reading lamps
 Lighting, accent LED
 Lighting, overhead LED
 Outlets, 120V (port and starboard, adjacent to bed)

Portholes, opening tinted inserts in main windows
 Skylight, foredeck with opening rectangular hatch
 Storage, bow cabinets
 Storage, overhead cabinets (port and starboard) with storage below
 Vanity, storage cabinet below
 Wardrobe with lighted stainless steel rod and cabinets below

Guest Head & Shower

A/C vent
 Bathroom accessories – toothbrush holder, towel hooks, soap dispenser, toilet paper holder
 Cabinets, mirrored
 Corian countertop with ceramic bowl and chrome faucet
 Extractor fan
 Flooring, molded fiberglass non-slip
 Lighting, overhead LED
 Outlet, 120V GFI protected
 Porthole, opening tinted with mosquito net
 Storage, cabinet
 Toilet with electric pump and macerator
 Separate shower area with hinged plexiglass door

- Cabinet, mirrored
- Corian panel
- Chrome shower system with overhead rain shower
- Porthole, opening tinted with mosquito net
- Seat, Corian

Starboard Side Guest Cabin

Carbon monoxide detector
 Bunks, convertible twin with polyurethane high resilience foam mattress, bed covers, and storage below (beds slide to form double bed)
 Flooring, carpet
 Lighting, accent LED
 Lighting, overhead LED
 Outlets, 120V
 Nightstand with storage drawer
 Porthole, opening tinted insert in main window with mosquito net
 Reading lamps
 Wardrobes with lighted stainless steel rod and cabinets below

SYSTEMS

Power & Drive Systems

Volvo Penta 2x D13-900 (2x 900 HP/662 kW) diesel engines

- Straight shaft transmission
- Propellers and rudder (bronze)
- Propeller shafts (stainless steel)
- Electronic Vessel Control System
- Exhaust, wet

Hydraulic steering system
 Trim tabs, hydraulic with indicators

Bilge

Automatic/manual fire extinguishing system
 Bilge pumps, automatic electric (3)
 Bilge pumps, high water alarm
 Common drain system
 Extractor fans (2)
 Lighting, LED
 Sound insulation

Air Conditioning

Air Conditioning System, Condaria Chilled water (84,000 BTU) – 240V

Electrical Systems

DC Electrical System (24V)

- Batteries
- Battery charger/converter
- Circuit breakers
- Integrated Management Information System (IMIS), Raymarine

 AC Electrical System (240V)

- Shore power, 240V/50A
- Circuit breakers
- Generator, Onan 17.5 kW diesel with sound shield (240V)
- Zincs

Fuel System

Fuel tanks (2), 316 stainless steel with air releases
 Fuel filters, (2) engines, (1) generator
 Fuel lines, USCG – Type A-1
 Fuel inlets, port and starboard aft deck
 Fuel stop valve, electromagnetic
 Fuel transfer system, manual valve

Fresh Water System

Water tanks (2), stainless steel with air releases
 Water inlets (2), one for each tank, stainless steel
 Water pump, 24V with filter
 Water heater, 21 GAL/80 L
 Dockside/shore water connection
 Level indicator

Waste System

Black Water Waste System

- Water tank, stainless steel with odor filter, water level sensor, and air release
- Waste pump, electric
- Level indicator
- Dockside pumpout fitting – stainless steel (starboard aft deck)
- Overboard waste discharge fitting

OTHER ITEMS

Owner's manual and engine manual



FACTORY OPTIONS

Color & Materials

Cabinetry

- Gloss Dark Walnut
- OR
- Gloss Beachwood

Mediterranean Design Package

- Please ask Sales Consultant for additional information or refer to sales brochure

Interior Upholstery

- White (Walnut Cabinetry)
- OR
- White and Grey (Beachwood Grey Cabinetry)

Window Treatments

- Wooden shutters

Shower Tile Mosaic

- Master shower
- Guest shower

Head Floor Tile

- Master head
- Guest head

Comfort Pack

Full control package

- Trip computer
- Cruise control
- Single lever function

Bow thruster, electric

Cablemaster

Entrance door curtain with SS loop to secure open

Covers for front window and side windows -

- black net structure

Cover for seats near flybridge steering console

Cover for flybridge steering console

Cover for sofa on flybridge

Cover for bow seating

Cover for cockpit sofa

Raymarine Chartplotter/FF 2x Axiom XL 16 (2x main station) 1x Axiom 12 Pro-S (1x flybridge) with CP370 transducer B744V and digital radar RD424 HD

Raymarine VHF Ray91 AIS (receiver) and VHF antenna with repater on flybridge

Raymarine autopilot Evolution DBW with 2x P70RS

control head, EV2 sensor core, EV2 cabling kit

Electric sliding TV LED SMART 50" with Blu-ray player in salon - Samsung

TV LED 32" with Blu-ray player in master cabin - Samsung

Luxury Pack

Beach Mode package - foldable aft balconies and sliding openable aft side windows, convertible bar area in side cockpit

Hydraulic movable bath platform with teak 1,100 LB/500 KG lifting capacity

Swim platform chocks

Skipper aft cabin

Electric toilet in crew cabin

Stern thruster, electric

Waterproof wood look floor in salon and galley

Carpets on floor in salon and galley

Washer and dryer in master cabin corridor

Ice maker on flybridge

Electric grill on flybridge

Fiberglass lowerable table in aft cockpit

Underwater LED lights (6)

Additional Raymarine Chartplotter 1x Axiom 12+ on flybridge station

Upgraded Magnum open radar antenna 48"

TV LED 24" with Blu-ray player in bow cabin

Audio system Fusion on bow, speakers (2)

Pre-wired third cabin AV

Soundbar system in salon

Safe in master cabin

Individual Options

Gyro stabilizer (1x Seakeeper 9)

Rear view camera + engine compartment camera (2 units)

Package eco - photovoltaic cells on the top of laminate hardtop (available only with solid roof)

Dishwasher in galley

Stainless steel anchor and chain (35 KG, 10/100 M)

Sunshade in front deck with carbon poles

Fitted sheet set



LAYOUT

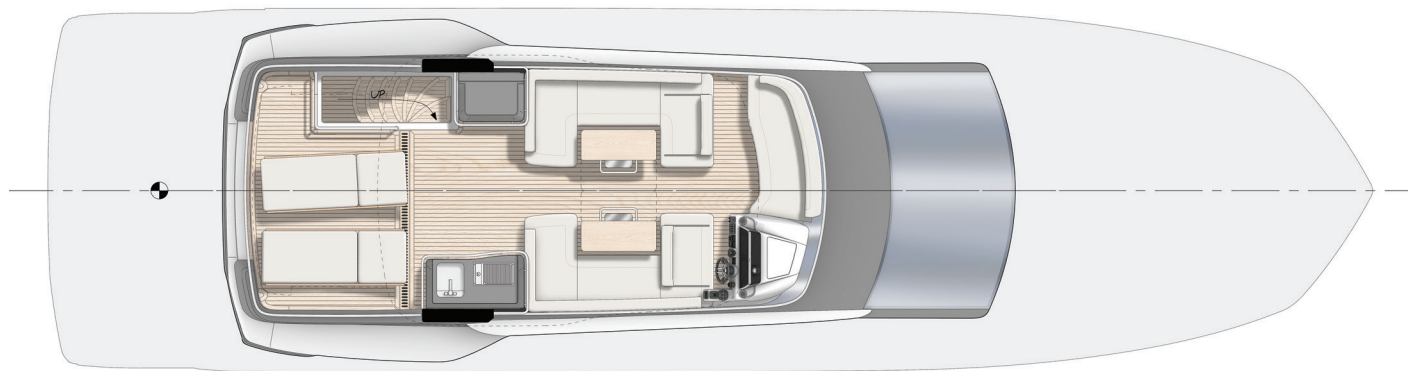

FLYBRIDGE

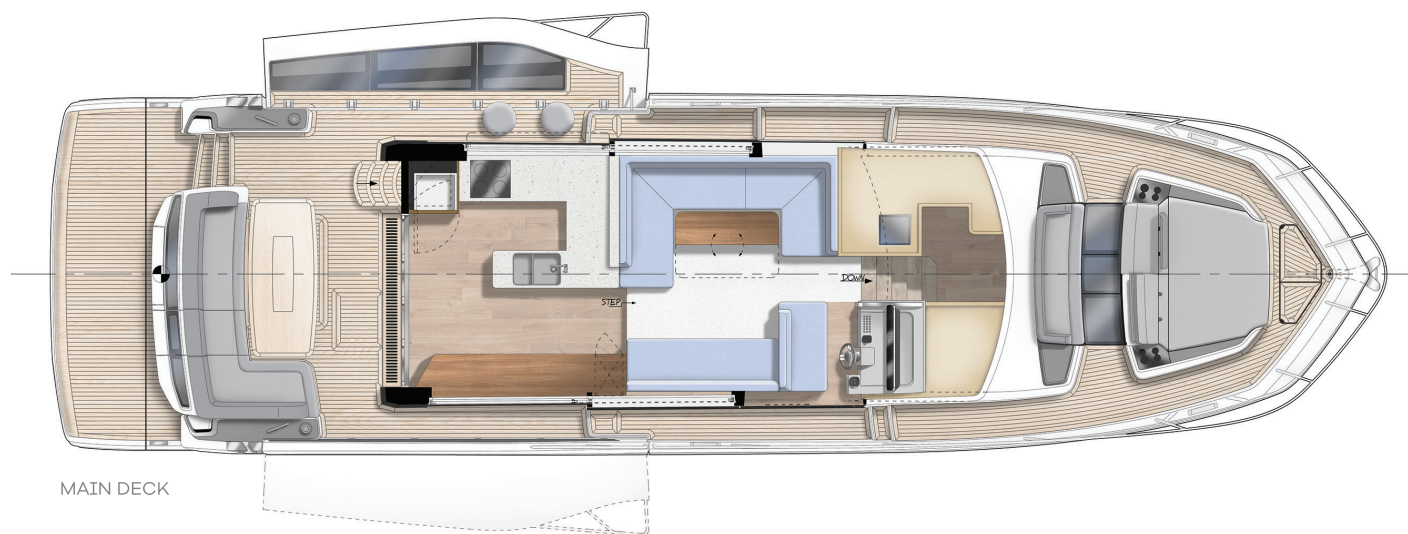

MAIN DECK



LOWER DECK

The right is reserved to make changes, without notice, at any time, in equipment, materials, and specifications. Drawings, photos, and renderings may show optional equipment.



