



560 *fly*

propulsion

TWIN VOLVO PENTA D13-900

[T-900 HP - 662 KW]

*cruising speed** **25** KNOTS

*maximum speed** **30** KNOTS

*The listed performance data is an estimate only based on vessel testing on fresh water with 6 people, full fuel and water and a clean hull bottom. The performance will change based on boating location, vessel loading and maintenance.

The specification measurements are approximate and subject to variance.

<i>length overall</i>	58' 6" / 17.9 M
<i>hull length</i>	53' 5" / 16.31 M
<i>beam</i>	15' 10" / 4.6 M
<i>beam (balconies down)</i>	22' 4" / 6.83 M
<i>dry weight</i>	60,894 LB / 27,621 KG
<i>maximum load weight</i>	72,812 LB / 33,027 KG
<i>draft (maximum)</i>	4' 6" / 1.4 M
<i>height (including mast light)</i>	23' 4" / 7.13 M
<i>fuel capacity</i>	580 GAL / 2,200 L
<i>water capacity</i>	185 GAL / 700 L
<i>black waste water capacity</i>	53 GAL / 200 L
<i>grey waste water capacity</i>	53 GAL / 200 L

GALEON
YACHTS
galeonyachts.us

fly

The 560 FLY first grabs the eye with lines that are both muscular and playful. A wide beam that carries well forward gives this vessel a substantial presence. It's a design choice that pulls double duty, allowing for unmatched interior volume, particularly on the accommodations level. But the 560 FLY has other attractive exterior aesthetics at play as well. This is a yacht with lines to remember.



Loads of glazing along the hull sides combine with massive windows on the main deck to create an airy and futuristic look.

Note: Layout and features may vary from shown here due to manufacturer consideration and client customization.

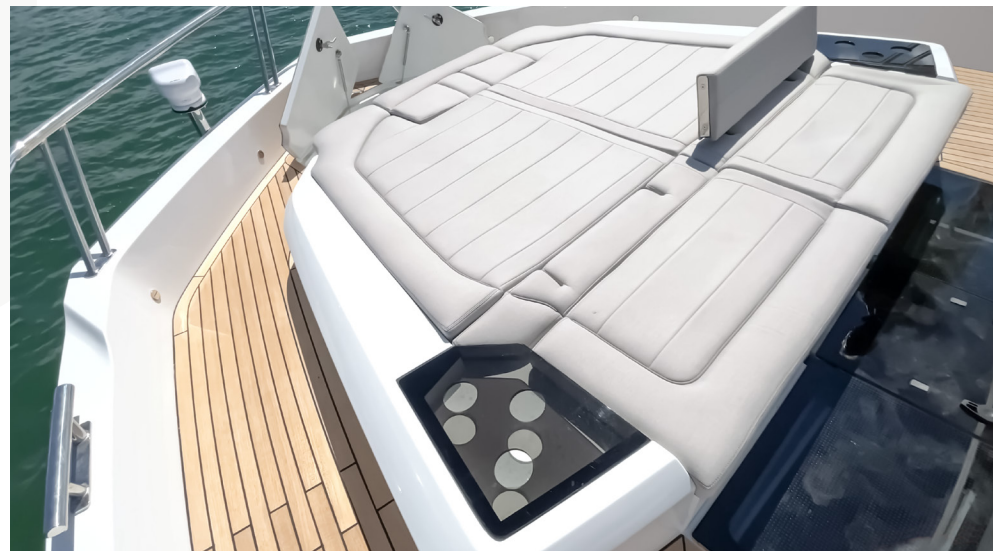

An expansive sunpad makes for an intimate setting for catching some rays, while also acting as another alfresco entertainment space.



Features abound. Fold-out Beach Mode balconies have glazing, so guests can see the water below their feet. A bar with three stools is to port, while there is an alfresco dining settee aft.

STANDARD FEATURES

EXTERIOR

Exterior Upholstery

- Tan & Mocha
- OR
- White & Mocha
- OR
- White & Silver

Hull & Deck Features

Bottom paint
Bow deck rail, 316 stainless steel with side access
Cleats, 16" stainless steel (8)
Fiberglass engine room air intakes and stainless steel outputs
Flooring, molded non-skid (bow and side deck)
Handrails, 316 stainless steel (cockpit and side deck)
Horn, electric
Lights, navigation
Mooring System

- Electric anchor winch with helm station and foot switches
- Anchor roller
- Galvanized anchor with galvanized chain
- Fiberglass deck hatch to self-draining chain locker

Rubrail, PVC with stainless steel insert
Galvanized anchor and galvanized chain
Spotlight, remote-controlled
Skylight, foredeck with opening rectangular hatch
Sunpad, foredeck

- Cup-holders, plexiglass
- Handrails, stainless steel
- Mattresses, with convertible backrests

Thru-hull fittings, stainless steel
Windows, bonded tempered glass (hullside) with integrated opening portholes
Windshield, tempered and tinted glass (bonded)
Windshield defroster

Cockpit Features

Door, salon entrance – three segment, stainless steel and glass, folding and lockable with flush threshold

Handrails, 316 stainless steel
Lighting, indirect LED (cockpit and stairs)
Lighting, overhead LED
Self-draining
Sofa, L-shaped upholstered
Speakers (2)
Stairs, access to flybridge (molded fiberglass with teak treads and stainless steel handrail)
Stairs, access to walkaround (molded, port and starboard)
Storage, side lockers
Teak, cockpit sole

Stern

Cleats, 11" stainless steel (2)
Door, cockpit access (fiberglass)
Lighting, indirect LED
Shore power inlet, 240V
Shower, fresh water (hot and cold)
Stairs, access to cockpit (molded, port)
Storage, aft deck lazarette with transom entrance and engine room access
Storage, side lockers
Swim platform, extended with collapsible three-step stainless steel swim ladder and teak decking

Flybridge

Flooring, molded non-skid
Handrails, 316 stainless steel
Helm station

- Compass
- Cupholders
- Helm seat, doublewide
- Outlets, USB
- Station instruments and controls
 - 7" Volvo Electronic Vessel Control (EVC) panel
 - Switches
 - Fire system monitor
 - Engine start panel
 - Trim tab control panel
 - Dual lever control, EVC
- Steering wheel, exclusive Galeon

Stereo, Fusion 12V AM/FM with bluetooth module and two speakers

Fiberglass arch with folding stainless steel radar mast
Hatch, skydeck access (plexiglass)
Light, anchor
Lighting, indirect LED
Outlet, 120 GFI
Seating, U-shape upholstered sofa with storage below
Sunpad, forward with doublewide starboard backrest for adjacent helm seating
Table, fiberglass
Venturi wind deflector, plexiglass with 316 stainless steel rails
Wetbar with:

- Fiberglass sink and retractable faucet
- Refrigerator (1.7 ft³/49 L)
- Storage

INTERIOR

Interior Color & Materials

Cabinetry

- Dark Walnut Matte
- OR
- Beachwood Matte

Window Treatments

- Roman Shades

Interior Color Schemes

- White
- OR
- Beige

Galley (aft)

Cooktop, 240V two-burner induction
Corian worktop with shelf
Extractor fan, overhead
Hatch, engine room access
Lighting, accent LED
Lighting, overhead LED
Microwave, 120V
Outlets, 120V GFI protected
Refrigerator, 240V upright with freezer compartment (5.8 ft³/165 L)
Refrigerator, 240V drawer (2.3 ft³/65 L)

Storage, cabinets and overhead cupboards
Sink, twin stainless steel with faucet and wood cutting board
Waterproof wood look floor

Salon

Carbon monoxide detector
Flooring, carpet
Corridor stairs, carpeted with indirect LED spot lights
Helm station (main)

- A/C vents
- Compass
- Cupholders
- Helm seat, doublewide with wood footrest
- Outlets, USB
- Station instruments and controls
 - Volvo 7" digital Electronic Vessel Control (EVC) panel
 - Switches
 - Fire system monitor
 - Engine start panel with electronic key fobs
 - Trim tab control panel
 - Dual lever control, EVC
 - Rudder indicator
 - Alarm, high water – bilge (2), cabin
- Steering wheel
- Synchronized twin windscreen wipers with front window washing system and defroster outlets

Lighting, overhead LED
Outlets, 120V
Seating, C-shape sofa with hi-lo wood dining table and filler cushion
Seating, opposing sofa
Side windows, panoramic electrically opening (port and starboard)
Speakers (2)
Storage, wall cabinets

Lower Corridor

Flooring, carpet
Lower accommodation stairs, carpeted with indirect LED spot lights
Door, access to guest head and shower with full length mirror

STANDARD FEATURES

Master Cabin (full beam, amidship)

Carbon monoxide detector
Door, private access to owner's head and shower with full length mirror
Berth, queen-size, centerline with polyurethane high resilience foam mattress, bed cover and storage below
Dresser, starboard side
Flooring, carpet
Headboard decoration with adjacent reading lamps
Lighting, accent LED
Lighting, overhead LED with wood detailing
Nightstands with storage, port and starboard
Outlets, 120V [port and starboard at nightstand]
Portholes, opening tinted inserts in main windows [port and starboard] with mosquito nets
Sofa, port side with vanity table, shelves and storage below
Storage, cabinet [entry hallway]
Wardrobe with lighted stainless steel rod

Master Head & Shower

A/C vent
Bathroom accessories – toothbrush holder, towel hooks, soap dispenser, toilet paper holder
Corian countertop with ceramic bowl and chrome faucet
Extractor fan
Flooring, molded fiberglass non-slip
Lighting, overhead LED
Mirror
Outlet, 120V GFI protected
Porthole, opening tinted with mosquito net
Storage, cabinets and shelving
Toilet with electric pump and macerator
Separate shower area w/ hinged plexiglass door

- Corian panel
- Chrome shower system with overhead rain shower
- Floor drain
- Porthole, opening tinted with mosquito net
- Storage, cabinet

Bow Guest Cabin

Carbon monoxide detector
Door, private access to guest head and shower with full length mirror

Berth, queen-size with polyurethane high resilience foam mattress, bed cover and drawer storage below
Flooring, carpet
Headboard, mirrored with adjacent reading lamps
Lighting, accent LED
Lighting, overhead LED
Outlets, 120V [port and starboard, adjacent to bed]
Portholes, opening tinted inserts in main windows [port and starboard] with mosquito nets
Skylight, foredeck with opening rectangular hatch
Storage, bow cabinets
Storage, overhead cabinets [port and starboard] with storage below
Vanity with storage cabinet below
Wardrobe with lighted stainless steel rod and cabinets below

Guest Head & Shower

A/C vent
Bathroom accessories – toothbrush holder, towel hooks, soap dispenser, toilet paper holder
Cabinets, mirrored
Corian countertop with ceramic bowl and chrome faucet
Extractor fan
Flooring, molded fiberglass non-slip
Lighting, overhead LED
Outlets, 120V GFI protected
Porthole, opening tinted with mosquito net
Storage, cabinet
Toilet with electric pump and macerator
Separate shower area w/hinged plexiglass door

- Cabinet, mirrored
- Corian panel
- Chrome shower system with overhead rain shower
- Porthole, opening tinted with mosquito net
- Seat, Corian

Starboard Side Guest Cabin

Carbon monoxide detector
Bunks, convertible twin with polyurethane high resilience foam mattress, bed cover and storage below [beds slide to form double bed]
Flooring, carpet

Lighting, accent LED
Lighting, overhead LED
Nightstand with storage drawer
Outlets, 120V
Porthole, opening tinted insert in main window with mosquito net
Reading lamps
Storage, overhead cabinets
Wardrobe with lighted stainless steel rod and cabinets below

SYSTEMS

Power & Drive Systems

Volvo Penta 2x D13-900 [900 HP/662 kW] diesel engines

- Straight shaft transmission
- Propellers [bronze]
- Propeller shafts [stainless steel]
- Electronic Vessel Control system
- Exhaust, wet

Hydraulic steering system

Rudder [bronze]

Trim tabs, hydraulic with indicators

Bilge

Automatic/manual fire extinguishing system

Bilge pumps, automatic electric [3]

Bilge pumps, high water alarm

Common drain system

Extractor fans [2]

Lighting, LED

Sound insulation

Air Conditioning

Air Conditioning System, Condaria chilled water [84,000 BTU] – 240V

Electrical Systems

DC Electrical System [24V]

- Batteries
- Battery charge/converter
- Circuit breakers
- Integrated Management Information System [IMIS], Raymarine

AC Electrical System 240V]

- Shore power, 240V/50A
- Circuit breakers
- Diesel generator with sound shield
- Zincs

Fuel System

Fuel tanks, 316 stainless steel [2] with air releases

Fuel filters, [3] Generator & Engines

Fuel lines, USCG – Type A-1

Fuel inlet, port and starboard aft deck

Fuel stop valve, electromagnetic

Fuel transfer system, manual valve

Fresh Water System

Water tanks, stainless steel [2] with air vents

Water inlets [2], one for each tank – stainless steel [starboard forward and aft deck]

Water pump, 24V with filter

Water heater, 21 GAL/80 L

Dockside/shore water connection

Level indicator

Waste System

Black Water Waste System

- Waste tank, stainless steel with odor filter, water level sensor and air release
- Waste pump, electric
- Level indicator
- Dockside pumpout fitting – stainless steel [starboard aft deck]
- Overboard waste discharge fitting

OTHER ITEMS

Owner's manual and engine manual

FACTORY OPTIONS

Color & Materials

Cabinetry

- Gloss Walnut
- OR
- Gloss Eucalyptus
- OR
- Matte Eucalyptus

Interior Upholstery

- White (Walnut Cabinetry)
- OR
- White and Grey (Beach Wood Grey Cabinetry)

Window Treatments

- Wooden shutters

Shower Tile Mosaic

- Master shower
- Guest shower

Head Floor Tile

- Master head
- Guest head

Comfort Pack

Full Control Package (trip computer, cruise control, single lever function)

Bow thruster with Joystick

Cablemaster

Entrance door curtain with SS loop to secure open

Covers for front window and side windows - black net structure

Cover for seats near flybridge steering console

Cover for flybridge steering console

Cover for sofa on flybridge

Raymarine Chartplotter/FF 3x Axiom XL 16 (2x main station and 1x flybridge) with CP370 transducer B744V and Magnum open array 4KW 48"

Additional Raymarine Chartplotter 1x Axiom XL 16+ on flybridge station

Raymarine VHF Ray91 AIS and VHF antenna with repater on flybridge

Raymarine autopilot Evolution DBW with 2x P70RS control head, EV2 sensor core, EV2 cabling kit

Electric sliding TV LED HD SMART 50" in salon - Samsung

TV LED 50" with Blu-ray in master cabin - Samsung

Luxury Pack

Beach Mode Package - foldable aft balconies and sliding openable aft side windows, convertible bar area in side cockpit

Hydraulic bath platform with 1,323 LB/600 KG platform maximum capacity

Swim platform chocks (H&B Technics adjustable cradle)

Skipper aft cabin

Electrical toilet in crew cabin

Stern thruster, electric with IP protection

Carpets on luxury vinyl plank floor in salon

Carpets on luxury vinyl plank floor in galley

Washer and dryer in master cabin corridor

Ice maker on flybridge

Electric grill on flybridge

Fiberglass foldable table in aft cockpit

Underwater LED lights (2 pcs)

TV LED 24" with Blu-ray in bow cabin

Soundbar system in salon

Safe in master cabin

Individual Option

Gyro stabilizer (Seakeeper 9)

Teak on side decks

Teak on flybridge

Raymarine augmented reality camera (AIS objects of the front camera screen)

Rear view camera + engine compartment camera (2 units)

Underwater LED lights (6 pcs)

Additional refrigeration (two drawers) - Indel Webasto Marine Drawer 65L in master cabin

Additional refrigeration (two drawers) - Indel Webasto Marine Drawer 65L in galley

Additional top-loading refrigerator Cube 40 in the flybridge bar

Dishwasher in galley

Wooden floor in galley and salon

Stainless steel anchor and chain (35 KG, 10/100 M)

Sunshade in front deck with carbon poles

Skipper aft store with toilet and air conditioning

Aft crew space to be fit out for storage and utility room in place of crew cabin with toilet and air conditioning

Lazarette storage for balcony stools and rope railings

fly

LAYOUT

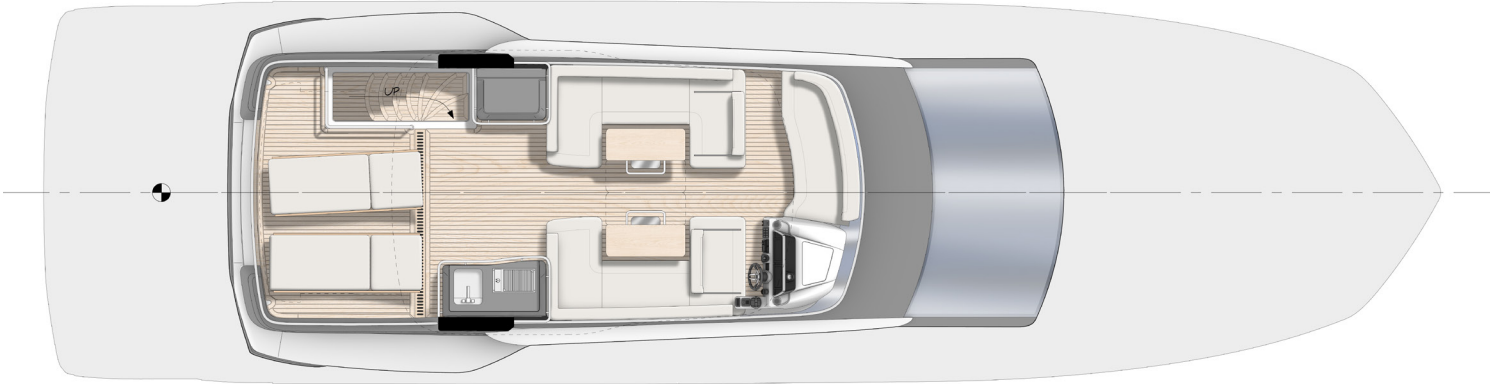

FLYBRIDGE

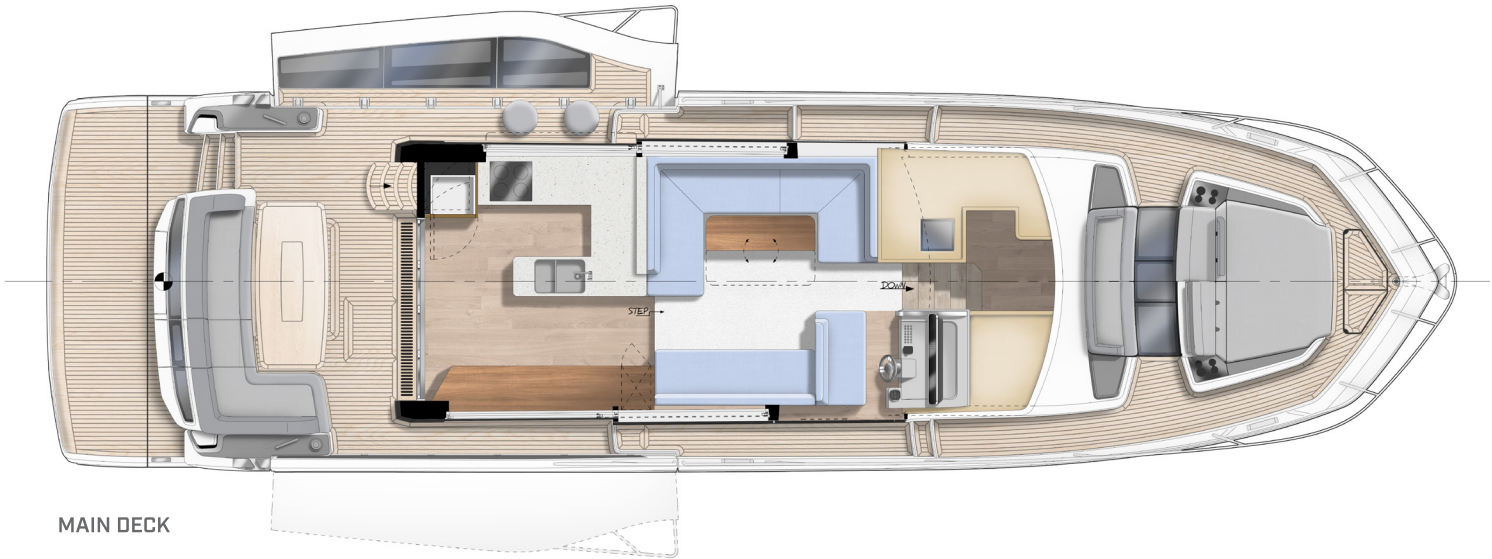

MAIN DECK



LOWER DECK

The right is reserved to make changes, without notice, at any time, in equipment, materials, and specifications. Drawings, photos, and renderings may show optional equipment.