

470 sky



propulsion

TWIN VOLVO PENTA D8-600

[T-600 HP - 448 kW]

cruising speed* **24** KNOTS

maximum speed* **29** KNOTS

*The listed performance data is an estimate only based on vessel testing on fresh water with 6 people, full fuel and water and a clean hull bottom. The performance will change based on boating location, vessel loading and maintenance.

length overall	47' 5" / 14.48 M
hull length	42' 4" / 12.92 M
beam	14' 2" / 4.33 M
beam (balconies down)	18' 7" / 5.7 M
dry weight	35,274 LB / 16,000 KG
maximum load weight	43,982 LB / 19,950 KG
draft (maximum)	4' 3" / 1.3 M
height (including mast light)	15' 10" / 4.6 M
fuel capacity	396 GAL / 1,500 L
water capacity	143 GAL / 650 L
black water capacity	53 GAL / 200 L

The specification measurements are approximate and subject to variance.

GALEON
YACHTS
galeonyachts.us

The 470 SKY joins the lineup bringing even more innovation to the Galeon Third Generation range. Based on the successful 460 FLY, it shares the same hull design and main deck layout allowing for great space for passengers and activities. With its sleek lines, one can easily mistake it for a hardtop model, and yet it offers a top deck neatly hidden away with a soft roof. Find a complete helm station with space for leisure on the sport flybridge.



The salon is well-lit thanks to multiple overhead skylights, large windows to port and starboard, and a steeply raked windshield.

Note: Layout and features may vary from shown here due to manufacturer consideration and client customization.

sky



Note the enormity of the hullside windows, which help bathe the master stateroom in natural light.



The fold-out terraces make an excellent location for an alfresco bar set-up.

470

STANDARD FEATURES

EXTERIOR

Exterior Upholstery

- Tan & Mocha
- OR
- White & Mocha
- OR
- White & Silver

Hull & Deck Accessories

Bottom paint
Bow deck rail, 316 stainless steel with side access
Cleats, stainless steel (8)
Fiberglass engine room air intakes and stainless steel outputs
Flooring, molded non-skid (bow and side deck)
Handrails, 316 stainless steel (cockpit and side deck)
Horn, electric
Lights, navigation
Mooring System

- Electric anchor winch with helm station
- Anchor roller
- Galvanized anchor, with galvanized chain
- Fiberglass deck hatch to self-draining chain locker

Rubrail, PVC with stainless steel insert
Spotlight, remote-controlled
Skylight, foredeck with opening rectangular hatch
Stairs, access to foredeck (molded mid-deck, port and starboard)
Seating, U-shaped foredeck sofa
Thru-hull fittings, stainless steel
Windows, hullside with opening tinted portholes
Windshield, expansive deckhouse - bonded tempered and tinted glass
Windshield defroster

Cockpit

Door, salon entrance – three segment, sliding and lockable with flush threshold
Flooring, molded non-skid
Handrails, 316 stainless steel
Hatch, engine room access
Lighting, indirect LED (cockpit and stairs)
Lighting, overhead LED

Self-draining
Sofa, L-shaped upholstered
Stairs, access to skydeck (teak treads and stainless steel handrail)
Storage, side lockers

Stern

Cleats, stainless steel (2)
Lighting, indirect LED
Seating, forward facing bench seat
Shore power inlet, 240V
Shower, fresh water (hot and cold)
Stairs, access to cockpit (molded, port)
Storage, aft lazarette with transom entrance
Storage, side lockers
Swim platform, extended with collapsible three-step stainless steel swim ladder and molded nonskid

Skydeck

Flooring, molded non-skid
Handrails, 316 stainless steel
Helm station

- Compass
- Cupholders
- Helm seat
- Outlets, USB
- Station instruments and controls
 - 7" Volvo Electronic Vessel Control (EVC) panel
 - Switches
 - Fire system monitor
 - Engine ignition panel
 - Trim tab control panel
 - Dual lever control, EVC
- Steering wheel, exclusive Galeon
- Stereo, Fusion 12V AM/FM with bluetooth module

Fiberglass arch with folding stainless steel radar mast

Hatch, flybridge access - watertight plexiglass
Light, anchor/stern
Lighting, indirect LED
Outlet, 120V GFI protected
Seating, aft C-shape upholstered sofa with storage
Speakers (2)

INTERIOR

Interior Color & Materials

Cabinetry

- Dark Walnut Matte

OR

- Beachwood Matte

Window Treatments

- Aluminum shutters with fabric blinds

Interior Upholstery

- Beige

Galley (aft)

Cooktop, 240V two-burner induction
Corian worktop with serving shelf
Extractor fan, overhead
Lighting, accent LED
Lighting, overhead LED
Microwave, 120V
Outlets, 120V GFI protected
Refrigerator, 240V under counter with freezer compartment [4.8 FT³/135 L]
Storage, cabinets and overhead cupboards
Sink, twin stainless steel with faucet
Waterproof wood look floor

Salon

Carbon monoxide detector
Flooring, carpet
Corridor stairs, carpeted with indirect LED spot lights
Helm station (main)

- A/C vents
- Compass
- Cupholders
- Helm seat, doublewide with wood footrest
- Outlets, USB
- Station instruments and controls
 - Volvo 7" digital Electronic Vessel Control (EVC) panel
 - Switches
 - Fire system monitor
 - Engine start panel with electronic key fobs
 - Trim tab control panel
 - Dual lever control, EVC
 - Rudder indicator
 - Alarm, high water – bilge (2), cabin

- Steering wheel
- Synchronized twin windscreen wipers with front window washing system and defroster outlets

Lighting, accent LED
Lighting, overhead LED
Outlets, 120V
Retracatable sunroof, electric
Seating, U-shape sofa with wood dining table
Seating, opposing sofa
Side Window, panoramic electrically opening (starboard)
Speakers (2)
Storage, cabinet

Lower Corridor

Flooring, carpet
Lower accommodation stairs, carpeted with indirect LED spot lights
Door, access to guest head and shower with full length mirror

Master Cabin (full beam, amidship)

Carbon monoxide detector
Door, private access to owner's head and shower with full length mirror
Bed, queen-size, centerline with polyurethane high resilience foam mattress, bed cover and storage below
Dressers, port and starboard sides
Flooring, carpet
Headboard decoration with adjacent reading lamps
Lighting, accent LED
Lighting, overhead LED
Nightstands with storage, port and starboard
Outlets, 120V (port and starboard at nightstand)
Storage, cabinet (entry hallway)
Wardrobe with lighted stainless steel rod

Master Head & Shower

A/C vent
Bathroom accessories – toothbrush holder, towel hooks, soap dispenser, toilet paper holder
Corian countertop with ceramic bowl and chrome faucet

STANDARD FEATURES

Extractor fan
Flooring, molded fiberglass non-slip
Lighting, overhead LED
Mirror
Outlet, 120V GFI protected
Porthole, opening tinted with mosquito net
Storage, cabinets and shelving
Toilet with electric pump and macerator
Separate shower area w/hinged plexiglass door

- Corian panel
- Chrome shower system
- Storage, cabinet
- Shower seat

Bow Guest Cabin

Carbon monoxide detector
Door, private access to guest head and shower
Bed, queen-size with polyurethane high resilience foam mattress, bed cover and drawer storage below
Flooring, carpet
Headboard, decorative with adjacent reading lamps
Lighting, accent LED
Lighting, overhead LED
Outlets, 120V (port and starboard, adjacent to bed)
Skylight, expansive foredeck with opening rectangular hatch and manual blinds
Storage, overhead and bedside cabinets (port and starboard)
Wardrobes (port and starboard) with lighted stainless steel rod

Guest Head & Shower

A/C vent
Bathroom accessories – toothbrush holder, towel hooks, soap dispenser, toilet paper holder
Cabinet, mirrored
Corian countertop with ceramic bowl and chrome faucet
Extractor fan
Flooring, molded fiberglass non-slip
Lighting, overhead LED

Outlet, 120V GFI protected
Porthole, opening tinted with mosquito net
Storage, cabinet
Separate toilet and shower area w/hinged plexiglass door

- Corian panel
- Chrome shower system
- Toilet with electric pump and macerator

Starboard Side Guest Cabin

Carbon monoxide detector
Twin-size bunkbeds with polyurethane high resilience foam mattresses and bed covers
Flooring, carpet
Lighting, overhead LED
Outlets, 120V
Reading lamps
Wardrobe with lighted stainless steel rod

SYSTEMS

Power & Drive Systems

Volvo Penta 2x 600-HP (2x 550 HP/448 kW) diesel engines

- V-drive transmission
- Propellers and rudder (bronze)
- Propeller shafts (stainless steel)
- Electronic Vessel Control system
- Exhaust, wet

Hydraulic steering system
Trim tabs, hydraulic with indicators

Bilge

Automatic/manual fire extinguishing system
Bilge pumps, automatic electric (2)
Bilge pumps, high water alarm
Common drain system
Extractor fans (2)
Lighting, LED
Sound insulation

Air Conditioning

Air Conditioning System, Dometic Chilled water (54,000 BTU) – 240V

Electrical Systems

DC Electrical System (24V)

- Batteries
- Battery charger/converter
- Circuit breakers
- DC main panel switchboard

AC Electrical System (240V)

- Shore power, 240V/50A with 50 ft. cord
- Circuit breakers
- Diesel generator with sound shield
- Zincs

Fuel System

Fuel tanks, 316 stainless steel (2) with air releases
Fuel filters, (3) generator and engines
Fuel lines, USCG – Type A-1
Fuel inlets, port and starboard
Fuel stop valve, electromagnetic
Fuel transfer system, manual valve

Fresh Water System

Water tank, stainless steel with air releases
Water inlet, stainless steel
Water pump, 24V with filter
Water heater, 16 GAL/60 L
Dockside/shore water connection
Level indicator

Waste System

Black Water Waste System

- Waste tank, stainless steel with odor filter, water level sensor and air release
- Waste pump, electric
- Level indicator
- Dockside pumpout fitting – stainless steel
- Overboard waste discharge

Grey Water System

- Sumps (2) automatic discharging overboard

OTHER ITEMS

Owner's manual and engine manual

FACTORY OPTIONS

Color & Materials

Cabinetry

- Gloss Walnut
- OR
- Gloss Eucalyptus
- OR
- Matte Eucalyptus

Interior Upholstery

- White (Walnut Cabinetry)
- OR
- White and Grey (Beach Wood Grey Cabinetry)

Comfort Pack

Full Control Package

Bow thruster, electric

Cablemaster

Entrance door curtain

Cover for cockpit seating

Cover for front window and side windows -
black net structure

Raymarine Chartplotter/FF 1x Axiom 12+ RV-US
and 1x Axiom 12 with transducer B744V and
digital radar RD424 HD

Additional Raymarine Chartplotter 1x Axiom 12
Pro-S on main station

Raymarine VHF Ray91 AIS and VHF antenna with
repeater on skydeck

Raymarine autopilot Evolution DBW with 2x P70RS
control head, EV2 sensor core, EV2 cabling kit

Electric Sliding TV LED 43" with Blu-ray in salon
TV LED 32" with Blu-ray in master cabin

Luxury Pack

Beach Mode Package - foldable aft balconies and
sliding openable aft side windows, convertible
bar area in side cockpit (only with D8-600
engines)

Electric grill on aft deck (only Carousel Mode
Package or Aft Dinner Mode Package)

Interior carpet runners (galley and salon)

TV LED 24" in bow cabin

Upgraded Fusion sound system with RA210 and
amplifier (2/2/2 speakers in salon/cockpit and
flybridge - JL speakers)

Add freezer drawer aft of standard refrigerator

Individual Options

Hydraulic bath platform with 882 LB/400 KG
platform maximum capacity

Carousel Mode Package - hydraulic openable
storage with rotating aft seat and grill area
(only with D8-600 engines)

Stern thruster, electric

Underwater LED lights (2 pcs)

Stainless steel anchor and chain (25 KG, 8/70 M)

LAYOUT

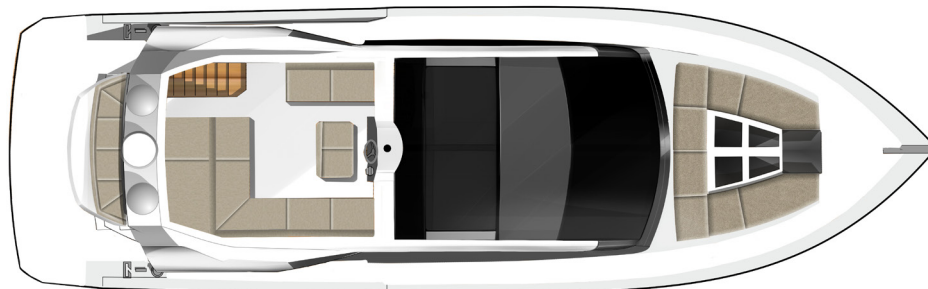

SKYDECK

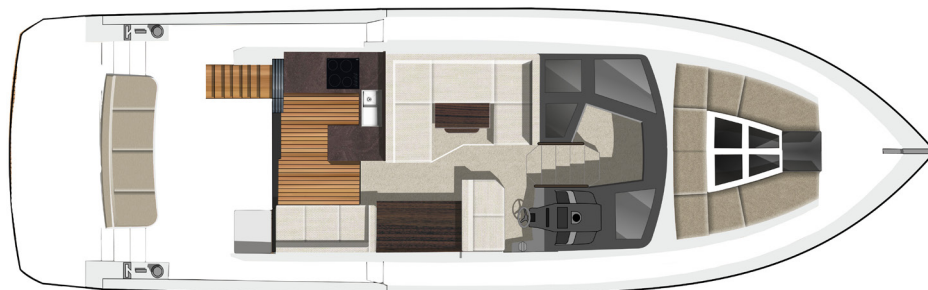

COCKPIT/MAIN DECK

Note: Cockpit seating different than shown for USA version. Galley to have cabinetry to starboard.

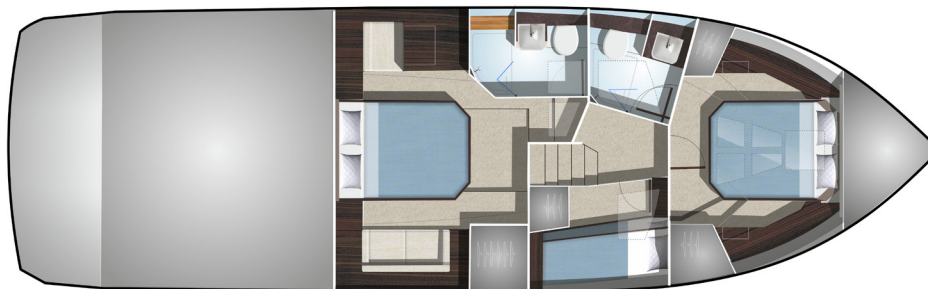

BELOW DECK

The right is reserved to make changes, without notice, at any time, in equipment, materials, and specifications. Drawings, photos, and renderings may show optional equipment.

