

425 *hts*



propulsion

**TWIN VOLVO PENTA IPS 500
WITH JOYSTICK
[06-370 HP - 272 KW]**

*cruising speed** **25 KNOTS**

*maximum speed** **30 KNOTS**

<i>length overall</i>	44' 1" / 13.44 M
<i>hull length</i>	39' 0" / 11.9 M
<i>beam</i>	12' 7" / 3.9 M
<i>dry weight</i>	27,400 LB / 12,425 KG
<i>maximum load weight</i>	33,500 LB / 15,195 KG
<i>draft (maximum)</i>	3' 4" / 1.0 M
<i>height (including mast light)</i>	13' 9" / 4.24 M
<i>fuel capacity</i>	209 GAL / 791 L
<i>water capacity</i>	119 GAL / 450 L
<i>black water capacity</i>	37 GAL / 140 L

*The listed performance data is an estimate only based on vessel testing on fresh water with 6 people, full fuel and water and a clean hull bottom. The performance will change based on boating location, vessel loading and maintenance.

The specification measurements are approximate and subject to variance.

GALEON
YACHTS
galeonyachts.us

The 425 HTS is a smaller sibling to the Galeon 485 HTS. We have re-invigorated the ever popular express style yacht by eliminating the need for soft curtains while still providing a truly open yacht. Close it up and enjoy the climate controlled cockpit or open the roof, doors, and windows and you can laugh about the old days of fighting canvas to stay dry from the approaching rain shower.



The 425's full-beam, amidships, master stateroom with an en suite head offers excellent privacy and keeps the owner well rested and refreshed

Note: Layout and features may vary from shown here due to manufacturer consideration and client customization.

hts



An alfresco dining settee in the cockpit that lets guests enjoy fresh sea breezes while taking their meals



Meals are prepared in a fully equipped galley down below that offers the chef peace and quiet while cooking

425

STANDARD FEATURES

EXTERIOR

Exterior Upholstery

- Tan & Mocha
- OR
- White & Mocha
- OR
- White & Silver

Hull & Deck Accessories

Bottom paint
Bow deck rail, 316 stainless steel with side access
Cleats, stainless steel 9½" (6)
Engine room ventilation
Permateek flooring (bow, side decks, and cockpit)
Handrails, 316 stainless steel (cockpit and side deck)
Horn, electric
Lights, navigation
Mooring System

- Reversible electric anchor winch
- Anchor roller
- Galvanized anchor, 44 LB (20 KG) with 197 FT (60 M) of 5/16" (8 MM) galvanized chain
- Fiberglass deck hatch to self-draining chain locker

Radar mast, stainless steel
Rubrail, PVC with stainless steel insert
Skylight, foredeck with opening rectangular hatch
Spotlight, remote-controlled
Thru-hull fittings, stainless steel
Windows, bonded tempered glass (hullside) with integrated opening portholes
Windshield, tempered and tinted glass (bonded), single pane forward glass
Windshield defroster

Cockpit

Door, cabin entrance – lockable, handrails, 316 stainless steel
Hardtop, fiberglass with electric sliding sunroof
Hatch, engine room access
Helm station

- Console rail, stainless steel
- Compass
- Cupholders, stainless steel
- Helm seat, double wide with flip up bolster and moveable back rest

- Station instruments and controls
 - Digital gauges
 - Switches
 - Alarm, high water – bilge, cabin
 - Engine start panel with electronic key fobs
 - Dual lever control, EVC
 - Fire system monitor
 - Joystick, Volvo Penta
 - Trim control – automatic, Zipwake
 - Outlet, USB
- Steering wheel
- Stereo remote control
- Synchronized twin windscreen wipers with front window washing system and defroster outlets

Lighting, indirect LED
Lighting, overhead LED
Outlet, 120V GFI protected
Self-draining
Aft-facing lounger
Seating, U-shape upholstered dinette
Speakers (2)
Storage port side locker
Tables (2), adjustable height
Drybar, stainless steel handrail, and storage cabinet
Window, flips up to open interior and exterior cockpit areas

Stern

Cleats, stainless steel retractable
Doors, cockpit access (stainless steel and fiberglass)
Handrail, 316 stainless steel
Lighting, indirect LED
Shore power inlet, 240V/50Amp
Shower, fresh water (hot and cold)
Stairs, access to walkaround (molded, port and starboard)
Swim platform with three-step stainless steel swim ladder, stainless steel grab handle and teak decking
Hydraulic opening with engine room access

INTERIOR

Interior Color & Materials

Cabinetry

- Dark Walnut Matte

- OR
 - Beachwood Matte
- Window Treatments
 - Curtains

Interior Upholstery
 - White
 - OR
 - Beige
 - OR
 - Grey

Galley

Cooktop, 120V two-burner induction
Corian worktop and finishings
Extractor fan
Lighting, overhead LED
Microwave, 120V
Outlet, 120V GFI protected
Porthole, opening tinted with mosquito net
Refrigerator, 12V with freezer compartment (4.6 ft³/130 L)
Skylight, cockpit
Storage, cupboards
Waterproof wood look floor
Waste basket

Master Cabin (aft)

Carbon monoxide detector
Door, private access to owner's head
Berth, queen-size with polyurethane high resilience foam mattress, bed cover
Flooring, carpet
Headboard, decorative
Lighting, overhead LED
Outlets, 120V (adjacent to bed)
Seating, double (starboard)
Storage, opening cupboard
Storage, large sideboard cabinet
Wardrobe with stainless steel rod
TV in stateroom

Master Head

A/C vent
Bathroom accessories – toothbrush holder, towel hooks, soap dispenser, toilet paper holder

Cabinets, mirrored
Corian countertop with fiberglass bowl and chrome faucet
Extractor fan
Flooring, molded non-slip
Lighting, overhead LED
Outlet, 120V GFI protected
Porthole, opening tinted with mosquito net
Storage, cupboards
Separate shower area w/hinged plexiglass doors

- Corian panel
- Chrome shower system
- Storage cupboard
- Toilet with macerator electric pump

Forward Cabin

Carbon monoxide detector
Berth, queen size with polyurethane mattress and storage below
Door, lockable
Flooring, carpet
Lighting, overhead LED
Outlet, 120V
Portholes, opening tinted with mosquito net
Reading lamps
Storage, upper cabinet
Wardrobe with stainless steel rod and shelving

Forward Head

A/C Vent
Bathroom accessories – toothbrush holder, towel hooks, soap dispenser, toilet paper holder
Corian countertop with fiberglass bowl and chrome faucet
Extractor fan
Flooring, molded non-slip
Lighting, overhead LED
Mirror
Outlet, 120V GFI protected
Storage, cupboards
Toilet with macerator electric pump
Shower curtain

- Chrome shower system

STANDARD FEATURES

SYSTEMS

Power & Drive Systems

2x Volvo Penta IPS 500 [2x D6-370 HP/272 kW]

with Joystick

- Duopropellers, bronze
- Electronic Vessel Control system

Hydraulic steering system

Trim control, automatic, Zipwake

Bilge

Automatic/manual fire extinguishing system

Bilge pumps, automatic electric [2] – engine room and aft cabin

Bilge pumps, high water alarm

Common drain system

Extractor fans [2]

Ladder, stainless steel

Lighting, LED

Sound insulation

Air Conditioning

Air Conditioning System, Dometic MarineAir [32,000 BTU]

Electrical Systems

DC Electrical System [12V]

- Batteries
- Battery charge/converter, 12V/80A
- Circuit breakers
- DC main switchboard

AC Electrical System [120V]

- Shore power, 240V/50Amp
- Circuit breakers
- Diesel generator with sound shield
- Galvanic isolator
- Zincs

Fuel System

Fuel tank, 316 stainless steel with air release

Fuel filters, 2 engine, 1 generator

Fuel lines, USCG – Type A-1

Fuel inlet

Fuel stop valve, electromagnetic (emergency button in side cockpit locker)

Fresh Water System

Water tank, stainless steel with air release

Water inlet, stainless steel – port bow deck

Water pump, automatic with filter

Water heater, 11 GAL/40 L

Dockside/shore water connection

Level indicator

Waste System

Grey Water Waste System

Sumps [2] with automatic pumps, discharging overboard

Black Water Waste System

- Waste tank, stainless steel with odor filter, water level sensor and air release
- Waste pump, electric – in engine room
- Level indicator and pump switch in starboard side cockpit locker
- Dockside pumpout fitting – stainless steel (starboard aft deck)
- Overboard waste discharge fitting

OTHER ITEMS

Owner's manual and engine manual

FACTORY OPTIONS

Color & Materials

Cabinetry

- Gloss Walnut

OR

- Gloss Eucalyptus

OR

- Matte Eucalyptus

Interior Upholstery

- White

OR

- Beige

Comfort Pack

Full Control Package (trip computer, cruise control, single lever function—for IPS)

Covers for front window and side windows - black net structure

Raymarine Chartplotter/FF 1x Axiom 12+ RV-US with transducer B60 and digital radar Quantum Q24C 18"

Raymarine VHF Ray91 AIS and VHF antenna

Raymarine autopilot Evolution DBW with P70RS control head, EV2 sensor core, EV2 cabling kit for Volvo DPI and IPS engines

TV LED 32" in salon – Samsung

DVD/Bluray in salon – Samsung

Cablemaster

Luxury Pack

Carpet on wooden floor in galley

Refrigerator in cockpit [49L]

TV LED 32" in aft cabin

TV LED 24" in bow cabin

Individual Option

Hydraulic bath platform with 882 LB/400 KG platform maximum capacity

Additional Raymarine Chartplotter 1x Axiom 12+ on main station

Upgraded Fusion sound system with RA210 and amplifier [4 speakers in salon/2 in cockpit – JL speakers + remote]

Cover for aft sofa in cockpit

Cover for sofa in cockpit

Stainless steel anchor and chain [20 KG, 8/60 M]

Underwater LED lights [2 aft and 2 side]

LAYOUT

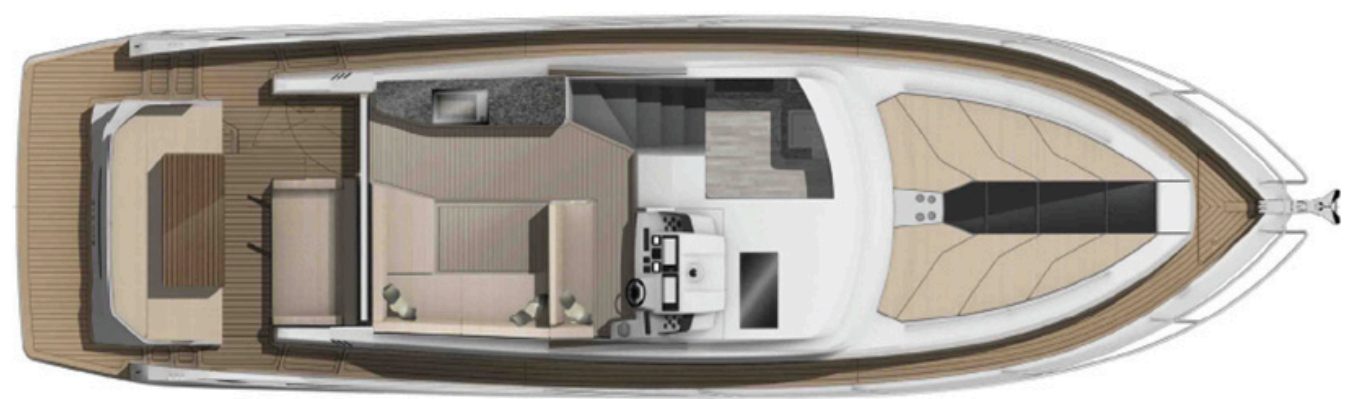

COCKPIT/MAIN DECK

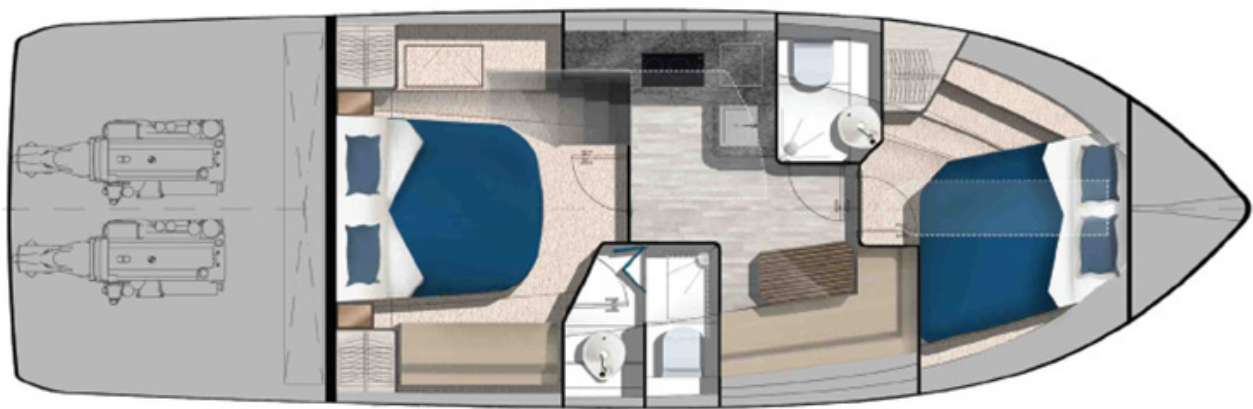

BELOW DECK

The right is reserved to make changes, without notice, at any time, in equipment, materials, and specifications. Drawings, photos, and renderings may show optional equipment.

